

data sheet:

FILCOTEN tec NW200

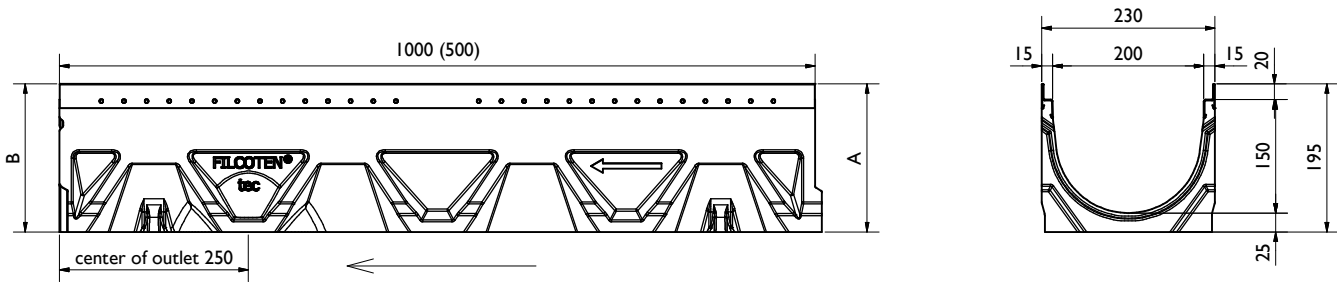

I. Rinne / Channel:
tec NW200 V-E



Rinne / channel - Maße / dimensions [mm]					
Typ	Höhe A height A	Höhe B height B	Länge length	BG code V	BG code E
0	195	195	1000	10220200	10220300
0 (0,5m)	195	195	500	10220250	10220350

Legende / explanation:	
V:	verzinkter Stahl / galvanized steel
E:	Edelstahl / stainless steel
G:	Gußeisen / ductil iron
H:	Holz / wood

2. Lochrost / Perforated grating:

C250kN d6: V 17020228 (17020229), E 17020328 (17020329)

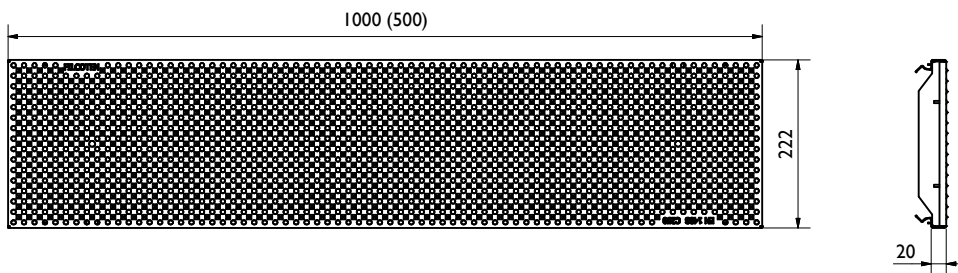

2. Gitterrost / Mesh grating:

B125kN MW30/10: V 17020220 (17020221), E17020320 (17020321)

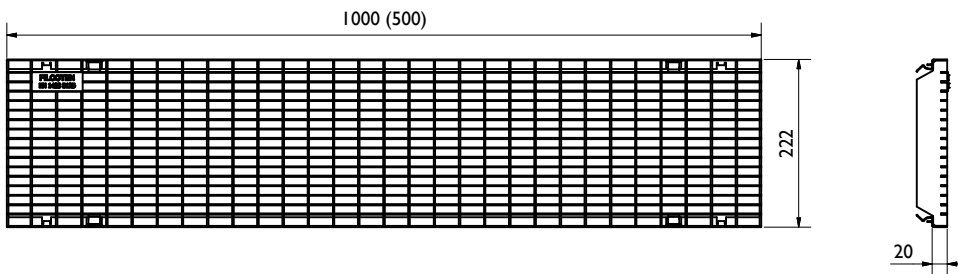

C250kN MW30/10: V 17020222 (17020223), E 17020322 (17020323)

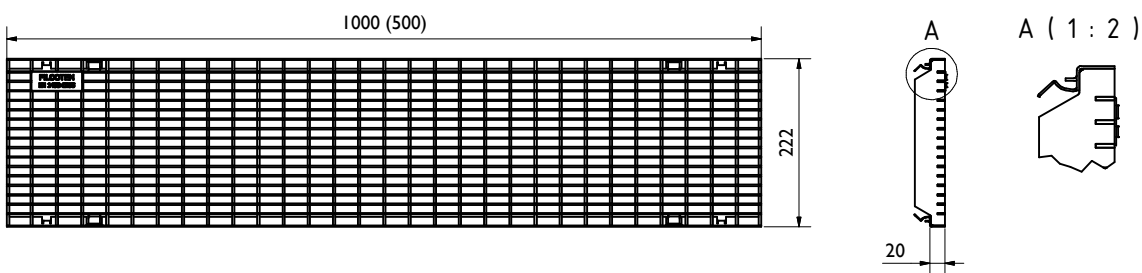

2. Gußrost / Ductil iron grating:

C250kN MW29/13: GJS 17020101

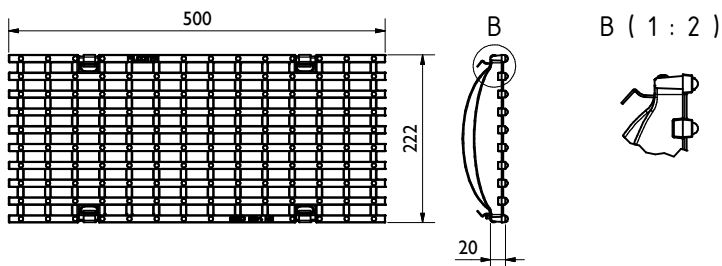

3. Sinkkasten / Sump unit:

(optional: Schlammeimer / Silt bucket: 22512)

V I0220291, EI0220391

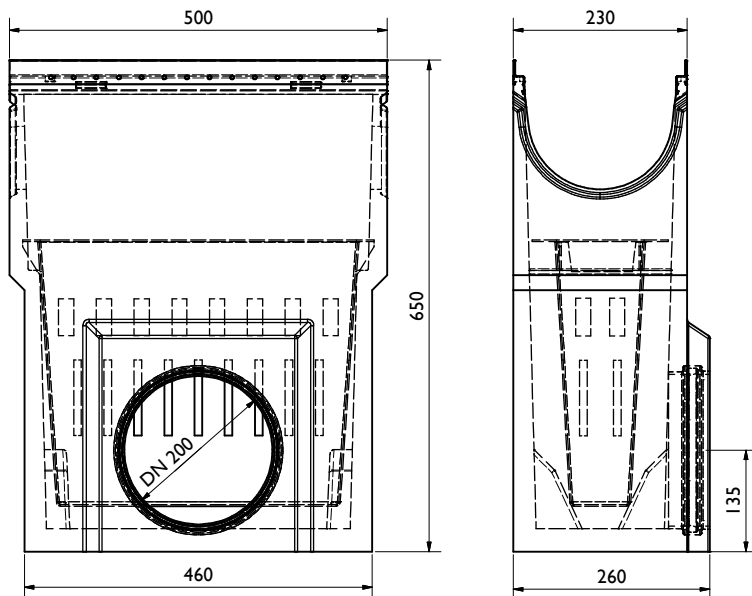

4. Stirn-/ Endplatte / End cap:

V I9020230, E I9020330

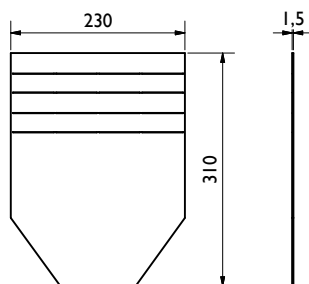

V I9020232, E I9020332

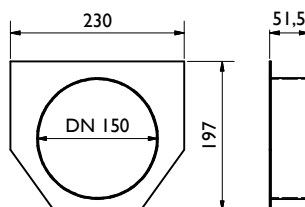

5. Vandalismus Verriegelung / Anti-vandalism locking device:

E 32089

